

BELT PATH

#6-32 CLAMPING BOLT.

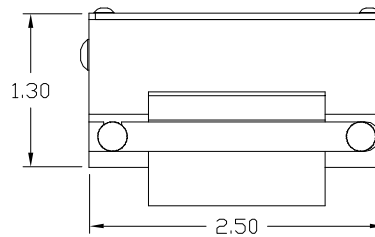

CABLE: 4 CONDUCTOR  
SHIELDED 10' LENGTH.

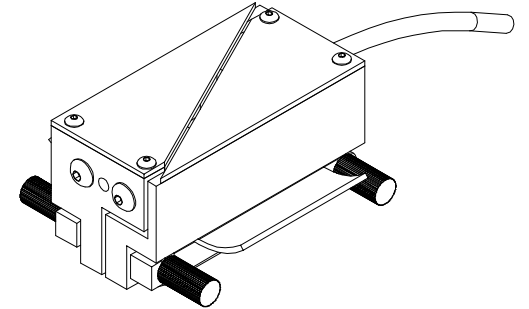

SEAT BELT TENSION LOAD CELL

CAPACITY 50 LBS.  
 OUTPUT 1.6 mV/V NOMINAL  
 BRIDGE RES. 350 OHMS  
 NON-LINEARITY  $\leq 0.25\%$  OF FULL SCALE  
 HYSTERESIS  $\leq 0.25\%$  OF FULL SCALE  
 BELT WIDTH 2.06 MAX.  
 BELT THICKNESS 0.06 MAX.  
 WEIGHT  $\sim .32$  MAX.  
 CABLE LENGTH 10 FT.

OPTIONAL TEMPERATURE COMPENSATION

TEMP. EFFECT ON ZERO  $\leq 0.002\%$  OF F.S./°F  
 TEMP. EFFECT ON SPAN  $\leq 0.002\%$  OF READING/°F

50LB SEAT BELT TENSION  
LOAD CELL

SCALE: 1 : 1	SHEET 1 OF 1	DRWN BY: C.HEAD
DATE: 06MAY04		MODEL: 6400
UNLESS OTHERWISE SPECIFIED		
TWO PLACE DECIMALS $\pm 0.010$	SURFACE FINISH 125 $\sqrt{\text{in}}$	
THREE PLACE DECIMALS $\pm 0.005$	REMOVE ALL BURRS & SHARP EDGES	
ANGLES $\pm 0^{\circ} 30'$	DIMENSION LIMITS HELD AFTER PLATING	
<b>ROBERT A. DENTON, INC.</b> ROCHESTER HILLS, MICHIGAN		DRAWING NUMBER: B-6400-D

SYM	REVISION	DATE	CAR#	INIT.